

平成二十七年三月測量

木津川本川縦断面図 (1)

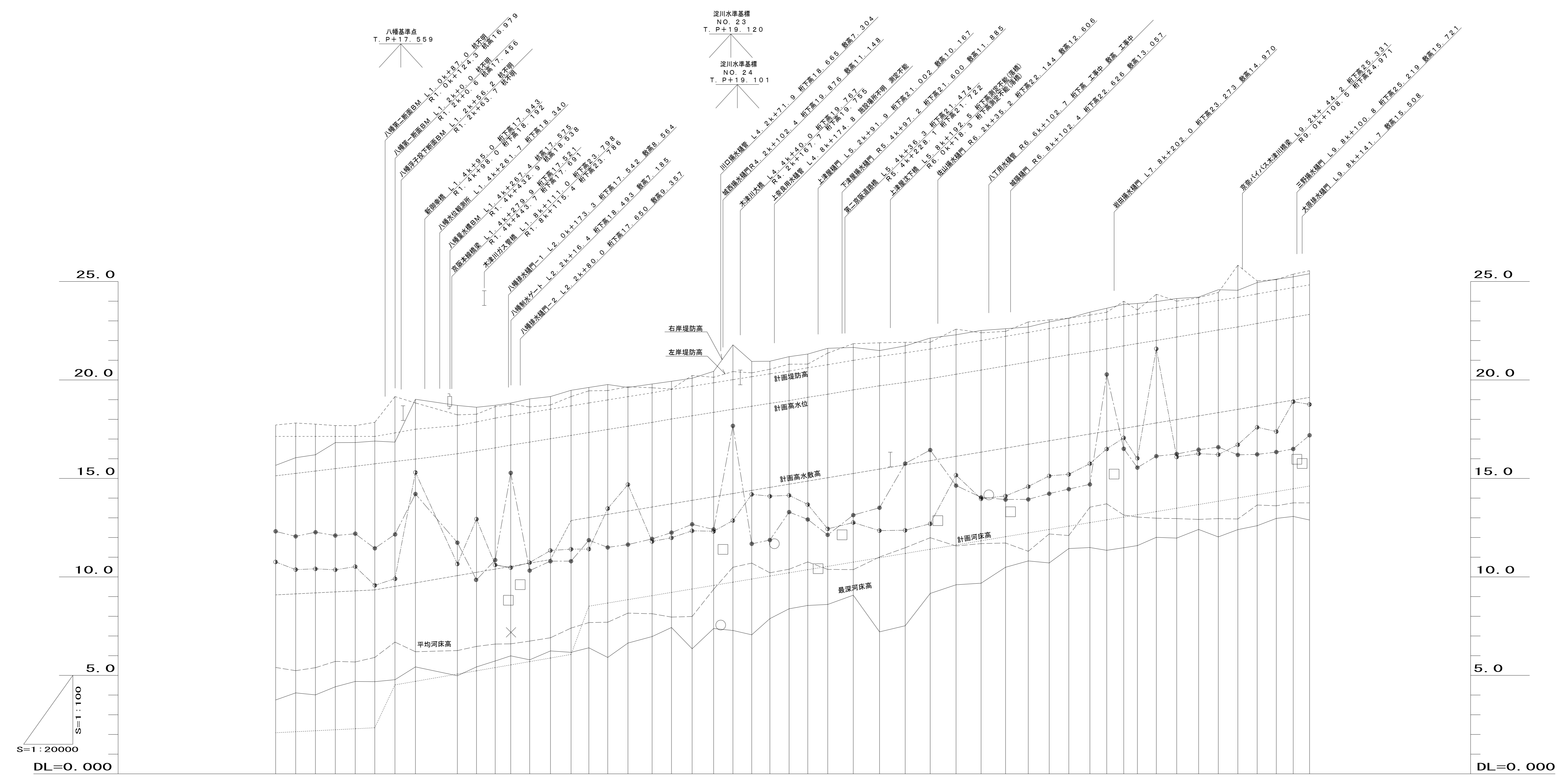

自 0.0 km
至 10.0 km

縮横 1:20000
尺縦 1:100

凡例	
量水標	
橋	
樋門・樋管・制水	
水準点	
計画	堤防高
	高水位
	高水敷高
	河床高
最深河床高	
堤防高	右岸
	左岸
平均河床高	
堤内地盤高	右岸
	左岸

現況河床勾配	
計画堤防高	
計画高水位	
計画高水敷高	
計画河床高	
平均河床高	
最深河床高	
堤防高	右岸 左岸
堤内地盤高	右岸 左岸
距離標高	右岸 左岸
右岸距離標追加距離	
左岸距離標追加距離	
流心追加距離	
流心区間距離	
距離標	

・距離標高・堤防高については本業務にて更新
・堤内地盤高・平均河床高・最深河床高については平成23年度木津川縦断面測量業務の成果値より記載

作業機関 株式会社 エース

計画機関 近畿地方整備局淀川河川事務所

木津川本川縦断面図(2)

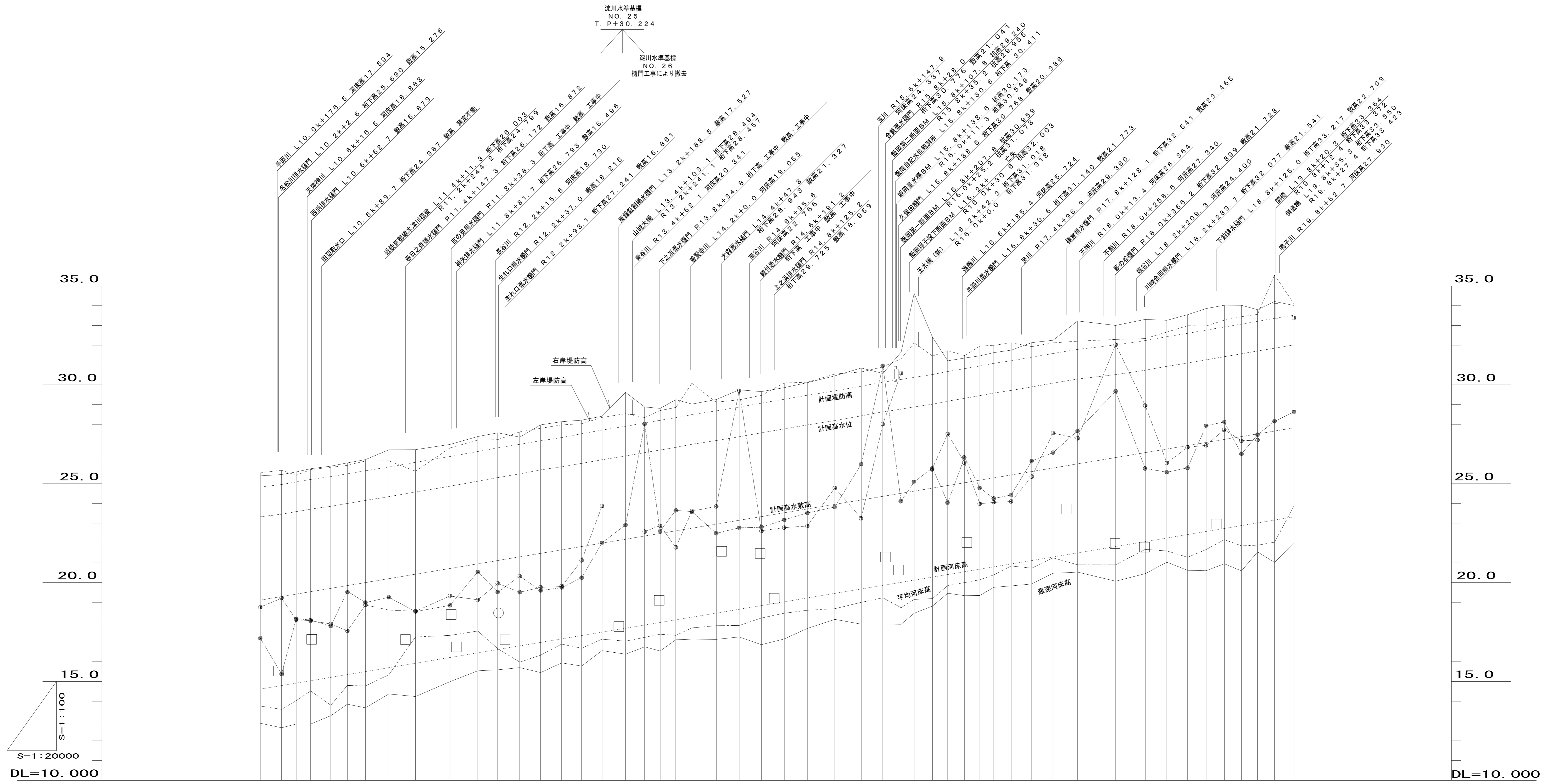

自 10.0 km
至 20.0 km

縮横 1:20000
尺縦 1:100

凡例		
量水標	○	
橋	I	
樋門・樋管・制水	□○×	
水準点	△	
計画	堤防高	——
	高水位	-----
	高水敷高	-----
最深河床高	右岸	-----
	左岸	-----
堤防高	右岸	-----
	左岸	-----
平均河床高	-----	
堤内地盤高	右岸	○
	左岸	●

現況河床勾配	
計画堤防高	10.00 105.0 100004.1 10412.0 10720.3 10943.0 11076.0 11209.0 11342.0 11475.0 11608.0 11741.0 11874.0 12007.0 12140.0 12273.0 12406.0 12539.0 12672.0 12805.0 12938.0 13071.0 13204.0 13337.0 13470.0 13603.0 13736.0 13869.0 14002.0 14135.0 14268.0 14401.0 14534.0 14667.0 14800.0 14933.0 15066.0 15199.0 15332.0 15465.0 15598.0 15731.0 15864.0 15997.0 16130.0 16263.0 16396.0 16529.0 16662.0 16795.0 16928.0 17061.0 17194.0 17327.0 17460.0 17593.0 17726.0 17859.0 17992.0 18125.0 18258.0 18391.0 18524.0 18657.0 18790.0 18923.0 19056.0 19189.0 19322.0 19455.0 19588.0 19721.0 19854.0 19987.0 20120.0 20253.0 20386.0 20519.0 20652.0 20785.0 20918.0 21051.0 21184.0 21317.0 21450.0 21583.0 21716.0 21849.0 21982.0 22115.0 22248.0 22381.0 22514.0 22647.0 22780.0 22913.0 23046.0 23179.0 23312.0 23445.0 23578.0 23711.0 23844.0 23977.0 24110.0 24243.0 24376.0 24509.0 24642.0 24775.0 24908.0 25041.0 25174.0 25307.0 25440.0 25573.0 25706.0 25839.0 25972.0 26105.0 26238.0 26371.0 26504.0 26637.0 26770.0 26903.0 27036.0 27169.0 27302.0 27435.0 27568.0 27701.0 27834.0 27967.0 28100.0 28233.0 28366.0 28499.0 28632.0 28765.0 28898.0 29031.0 29164.0 29297.0 29430.0 29563.0 29696.0 29829.0 29962.0 30095.0 30228.0 30361.0 30494.0 30627.0 30760.0 30893.0 31026.0 31159.0 31292.0 31425.0 31558.0 31691.0 31824.0 31957.0 32090.0 32223.0 32356.0 32489.0 32622.0 32755.0 32888.0 33021.0 33154.0 33287.0 33420.0 33553.0 33686.0 33819.0 33952.0 34085.0 34218.0 34351.0 34484.0 34617.0 34750.0 34883.0 35016.0 35149.0 35282.0 35415.0 35548.0 35681.0 35814.0 35947.0 36080.0 36213.0 36346.0 36479.0 36612.0 36745.0 36878.0 37011.0 37144.0 37277.0 37410.0 37543.0 37676.0 37809.0 37942.0 38075.0 38208.0 38341.0 38474.0 38607.0 38740.0 38873.0 39006.0 39139.0 39272.0 39405.0 39538.0 39671.0 39804.0 39937.0 40070.0 40203.0 40336.0 40469.0 40602.0 40735.0 40868.0 41001.0 41134.0 41267.0 41400.0 41533.0 41666.0 41799.0 41932.0 42065.0 42198.0 42331.0 42464.0 42597.0 42730.0 42863.0 42996.0 43129.0 43262.0 43395.0 43528.0 43661.0 43794.0 43927.0 44060.0 44193.0 44326.0 44459.0 44592.0 44725.0 44858.0 44991.0 45124.0 45257.0 45390.0 45523.0 45656.0 45789.0 45922.0 46055.0 46188.0 46321.0 46454.0 46587.0 46720.0 46853.0 46986.0 47119.0 47252.0 47385.0 47518.0 47651.0 47784.0 47917.0 48050.0 48183.0 48316.0 48449.0 48582.0 48715.0 48848.0 48981.0 49114.0 49247.0 49380.0 49513.0 49646.0 49779.0 49912.0 50045.0 50178.0 50311.0 50444.0 50577.0 50710.0 50843.0 50976.0 51109.0 51242.0 51375.0 51508.0 51641.0 51774.0 51907.0 52040.0 52173.0 52306.0 52439.0 52572.0 52705.0 52838.0 52971.0 53104.0 53237.0 53370.0 53503.0 53636.0 53769.0 53902.0 54035.0 54168.0 54301.0 54434.0 54567.0 54700.0 54833.0 54966.0 55099.0 55232.0 55365.0 55498.0 55631.0 55764.0 55897.0 56030.0 56163.0 56296.0 56429.0 56562.0 56695.0 56828.0 56961.0 57094.0 57227.0 57360.0 57493.0 57626.0 57759.0 57892.0 58025.0 58158.0 58291.0 58424.0 58557.0 58690.0 58823.0 58956.0 59089.0 59222.0 59355.0 59488.0 59621.0 59754.0 59887.0 60020.0 60153.0 60286.0 60419.0 60552.0 60685.0 60818.0 60951.0 61084.0 61217.0 61350.0 61483.0 61616.0 61749.0 61882.0 62015.0 62148.0 62281.0 62414.0 62547.0 62680.0 62813.0 62946.0 63079.0 63212.0 63345.0 63478.0 63611.0 63744.0 63877.0 64010.0 64143.0 64276.0 64409.0 64542.0 64675.0 64808.0 64941.0 65074.0 65207.0 65340.0 65473.0 65606.0 65739.0 65872.0 66005.0 66138.0 66271.0 66404.0 66537.0 66670.0 66803.0 66936.0 67069.0 67202.0 67335.0 67468.0 67601.0 67734.0 67867.0 68000.0 68133.0 68266.0 68399.0 68532.0 68665.0 68798.0 68931.0 69064.0 69197.0 69330.0 69463.0 69596.0 69729.0 69862.0 69995.0 70128.0 70261.0 70394.0 70527.0 70660.0 70793.0 70926.0 71059.0 71192.0 71325.0 71458.0 71591.0 71724.0 71857.0 71990.0 72123.0 72256.0 72389.0 72522.0 72655.0 72788.0 72921.0 73054.0 73187.0 73320.0 73453.0 73586.0 73719.0 73852.0 73985.0 74118.0 74251.0 74384.0 74517.0 74650.0 74783.0 74916.0 75049.0 75182.0 75315.0 75448.0 75581.0 75714.0 75847.0 75980.0 76113.0 76246.0 76379.0 76512.0 76645.0 76778.0 76911.0 77044.0 77177.0 77310.0 77443.0 77576.0 77709.0 77842.0 77975.0 78108.0 78241.0 78374.0 78507.0 78640.0 78773.0 78906.0 79039.0 79172.0 79305.0 79438.0 79571.0 79704.0 79837.0 79970.0 80103.0 80236.0 80369.0 80502.0 80635.0 80768.0 80901.0 81034.0 81167.0 81300.0 81433.0 81566.0 81699.0 81832.0 81965.0 82098.0 82231.0 82364.0 82497.0 82630.0 82763.0 82896.0 83029.0 83162.0 83295.0 83428.0 83561.0 83694.0 83827.0 83960.0 84093.0 84226.0 84359.0 84492.0 84625.0 84758.0 84891.0 85024.0 85157.0 85290.0 85423.0 85556.0 85689.0 85822.0 85955.0 86088.0 86221.0 86354.0 86487.0 86620.0 86753.0 86886.0 87019.0 87152.0 87285.0 87418.0 87551.0 87684.0 87817.0 87950.0 88083.0 88216.0 88349.0 88482.0 88615.0 88748.0 88881.0 89014.0 89147.0 89280.0 89413.0 89546.0 89679.0 89812.0 89945.0 90078.0 90211.0 90344.0 90477.0 90610.0 90743.0 90876.0 91009.0 91142.0 91275.0 91408.0 91541.0 91674.0 91807.0 91940.0 92073.0 92206.0 92339.0 92472.0 92605.0 92738.0 92871.0 93004.0 93137.0 93270.0 93403.0 93536.0 93669.0 93802.0 93935.0 94068.0 94201.0 94334.0 94467.0 94600.0 94733.0 94866.0 94999.0 95132.0 95265.0 95398.0 95531.0 95664.0 95797.0 95930.0 96063.0 96196.0 96329.0 96462.0 96595.0 96728.0 96861.0 96994.0 97127.0 97260.0 97393.0 97526.0 97659.0 97792.0 97925.0 98058.0 98191.0 98324.0 98457.0 98590.0 98723.0 98856.0 98989.0 99122.0 99255.0 99388.0 99521.0 99654.0 99787.0 99920.0 100053.0 100186.0 100319.0 100452.0 100585.0 100718.0 100851.0 100984.0 101117.0 101250.0 101383.0 101516.0 101649.0 101782.0 101915.0 102048.0 102181.0 102314.0 102447.0 102580.0 102713.0 102846.0 102979.0 103112.0 103245.0 103378.0 103511.0 103644.0 103777.0 103910.0 104043.0 104176.0 104309.0 104442.0 104575.0 104708.0 104841.0 104974.0 105107.0 105240.0 105373.0 105506.0 105639.0 105772.0 105905.0 106038.0 106171.0 106304.0 106437.0 106570.0 106703.0 106836.0 106969.0 107102.0 107235.0 107368.0 107501.0 107634.0 107767.0 107900.0 108033.0 108166.0 108299.0 108432.0 108565.0 108698.0 108831.0 108964.0 109097.0 109230.0 109363.0 109496.0 109629.0 109762.0 109895.0 110028.0 110161.0 110294.0 110427.0 110560.0 110693.0 110826.0 110959.0 111092.0 111225.0 111358.0 111491.0 111624.0 111757.0 111890.0 112023.0 112156.0 112289.0 112422.0 112555.0 112688.0 112821.0 112954.0 113087.0 113220.0 113353.0 113486.0 113619.0 113752.0 113885.0 114018.0 114151.0 114284.0 114417.0 114550.0 114683.0 114816.0 114949.0 115082.0 115215.0 115348.0 115481.0 115614.0 115747.0 115880.0 116013.0 116146.0 116279.0 116412.0 116545.0 116678.0 116811.0 116944.0 117077.0 117210.0 117343.0 117476.0 117609.0 117742.0 117875.0 118008.0 118141.0 118274.0 118407.0 118540.0 118673.0 118806.0 118939.0 119072.0 119205.0 119338.0 119471.0 119604.0 119737.0 119870.0 120003.0 120136.0 120269.0 120402.0 120535.0 120668.0 120801.0 120934.0 121067.0 121200.0 121333.0 121466.0 121599.0 121732.0 121865.0 121998.0 122131.0 122264.0 122397.0 122530.0 122663.0 122796.0 122929.0 123062.0 123195.0 123328.0 123461.0 123594.0 123727.0 123860.0 123993.0 124126.0 124259.0 124392.0 124525.0 124658.0 124791.0 124924.0 125057.0 125190.0 125323.0 125456.0 125589.0 125722.0 125855.0 125988.0 126121.0 126254.0 126387.0 126520.0 126653.0 126786.0 126919.0 127052.0 127185.0 127318.0 127451.0 127584.0 127717.0 127850.0 127983.0 128116.0 128249.0 128382.0 128515.0 128648.0 128781.0 128914.0 129047.0 129180.0 129313.0 129446.0 129579.0 129712.0 129845.0 129978.0 130111.0 130244.0 130377.0 130510.0 130643.0 130776.0 130909.0 131042.0 131175.0 131308.0 131441.0 131574.0 131707.0 131840.0 131973.0 132106.0 132239.0 132372.0 132505.0 132638.0 132771.0 132904.0 133037.0 133170.0 133303.0 133436.0 133569.0 133702.0 133835.0 133968.0 134101.0 134234.0 134367.0 134500.0 134633.0 134766.0 134899.0 135032.0 135165.0 135298.0 135431.0 135564.0 135697.0 135830.0 135963.0 136096.0 136229.0 136362.0 136495.0 136628.0 136761.0 136894.0 137027.0 137160.0 137293.0 137426.0 137559.0 137692.0 137825.0 137958.0 138091.0 138224.0 138357.0 138490.0 138623.0 138756.0 138889.0 139022.0 139155.0 139288.0 139421.0 139554.0 139687.0 139820.0 139953.0 140086.0 140219.0 140352.0 140485.0 140618.0 140751.0 140884.0 141017.0 141150.0 141283.0 141416.0 141549.0 141682.0 141815.0 141948.0 142081.0 142214.0 142347.0 142480.0 142613.0 142746.0 142879.0 143012.0 143145.0 143278.0 143411.0 143544.0 143677.0 143810.0 143943.0 144076.0 144209.0 144342.0 144475.0 144608.0 144741.0 144874.0 145007.0 145140.0 145273.0 145406.0 145539.0 145672.0 145805.0 145938.0 146071.0 146204.0 146337.0 146470.0 146603.0 146736.0 146869.0 147002.0 147135.0 147268.0 147401.0 147534.0 147667.0 147800.0 147933.0 148066.0 148199.0 148332.0 148465.0 148598.0 148731.0 148864.0 148997.0 149130.0 149263.0 149396.0 149529.0 149662.0 149795.0 149928.0 150061.0 150194.0 150327.0 150460.0 150593.0 150726.0 150859.0 150992.0 151125.0 151258.0 151391.0 151524.0 151657.0 151790.0 151923.0 152056.0 152189.0 152322.0 152455.0 152588.0 152721.0 152854.0 152987.0 153120.0 153253.0 153386.0 153519.0 153652.0 153785.0 153918.0 154051.0 154184.0 154317.0 154450.0 154583.0 154716.0 154849.0 154982.0 155115.0 155248.0 155381.0 155514.0 155647.0 155780.0 155913.0 156046.0 156179.0 156312.0 156445.0 156578.0 156711.0 156844.0 156977.0 157110.0 157243.0 157376.0 157509.0 157642.0 157775.0 157908.0 158041.0 158174.0 158307.0 158440.0 158573.0 158706.0 158839.0 158972.0 159105.0 159238.0 159371.0 159504.0 159637.0 159770.0 159903.0 160036.0 160169.0 160302.0 160435.0 160568.0 160701.0 160834.0 160967.0 161100.0 161233.0 161366.0 161499.0 161632.0 161765.0 161898.0 162031.0 162164.0 162297.0 162430.0 162563.0 162696.0 162829.0 162962.0 163095.0 163228.0 163361.0 163494.0 163627.0 163760.0 163893.0 164026.0 164159.0 164292.0 164425.0 164558.0 164691.0 164824.0 164957.0 165090.0 165223.0 165356.0 165489.0 165622.0 165755.0 165888.0 166021.0 166154.0 166287.0 166420.0 166553.0 166686.0 166819.0 166952.0 167085.0 167218.0 167351.0 167484.0 167617.0 167750.0 167883.0 168016.0 168149.0 168282.0 168415.0 168548.0 168681.0 168814.0 168947.0 169080.0 169213.0 169346.0 169479.0 169612.0 169745.0 169878.0 170011.0 170144.0 170277.0 170410.0 170543.0 170676.0 170809.0 170942.0 171075.0 171208.0 171341.0 171474.0 171607.0 171740.0 171873.0 172006.0 172139.0 172272.0 172405.0 172538.0 172671.0 172804.0 172937.0 173070.0 173203.0 173336.0 173469.0 173602.0 173735.0 173868.0 174001.0 174134.0 174267.0 174400.0 174533.0 174666.0 174799.0 174932.0 175065.0 175198.0 175331.0 175464.0 175597.0 175730.0 175863.0 175996.0 176129.0 176262.0 176395.0 176528.0 176661.0 176794.0 176927.0 177060.0 177193.0 177326.0 177459.0 177592.0 177725.0 177858.0 177991.0 178124.0 178257.0 178390.0 178523.0 178656.0 178789.0 178922.0 179055.0 179188.0 179321.0 179454.0 179587.0 179720.0 179853.0 179986.0 180119.0 180252.0 180385.0 180518.0 180651.0 180784.0 180917.0 181050.0 181183.0 181316.0 181449.0 181582.0 181715.0 181848.0 181981.0 182114.0 182247.0 182380.0 182513.0 182646.0 182779.0 182912.0 183045.0 183178.0 183311.0 183444.0 183577.0 183710.0 183843.0 183976.0 184109.0 184242.0 184375.0 184508.0 184641.0 184774.0 184907.0 185040.0 185173.0 185306.0 185439.0 185572.0 185705.0 185838.0 185971.0 186104.0 186237.0 186370.0 186503.0 186636.0 186769.0 186902.0 187035.0 187168.0 187301.0 187434.0 187567.0 187700.0 187833.0 187966.0 188099.0 188232.0 188365.0 188498.0 188631.0 188764.0 188897.0 189030.0 1891

木津川本川縦断面図(3)

自 20.0km 至 30.0km

縮横 1:20000 尺縦 1:100

Table with 2 columns: 凡例 (Legend) and symbols. It defines symbols for water level, bridge, gate, dam, and various elevation types (planned, actual, average, deepest).

・距離標・堤防高については本業務にて更新
・堤内地盤高・平均河床高・最深河床高については平成23年度木津川縦断面測量業務の成果値より記載

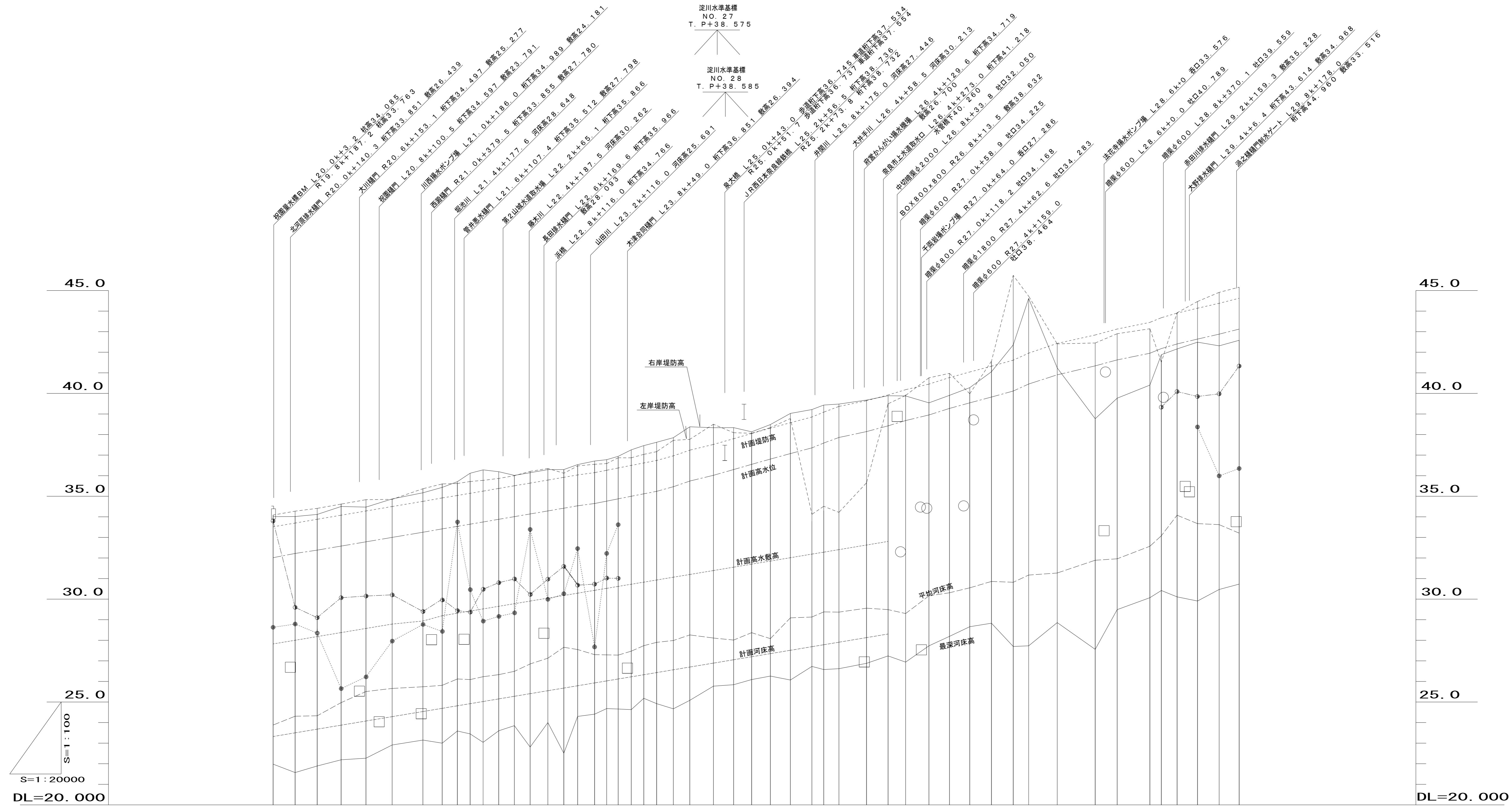

Table with 14 rows and 1 column. The rows are: 現況河床勾配, 計画堤防高, 計画高水位, 計画高水敷高, 計画河床高, 平均河床高, 最深河床高, 堤防高 (Right Bank, Left Bank), 堤内地盤高 (Right Bank, Left Bank), 距離標高 (Right Bank, Left Bank), 右岸距離標追加距離, 左岸距離標追加距離, 流心追加距離, 流心区間距離, 距離標. The table contains numerical data for each of these categories across the 20.0km to 30.0km range.

平成二十七年三月測量

木津川本川縦断面図(4)

自 30.0km
至 37.2km

縮横 1:20000
尺縦 1:100

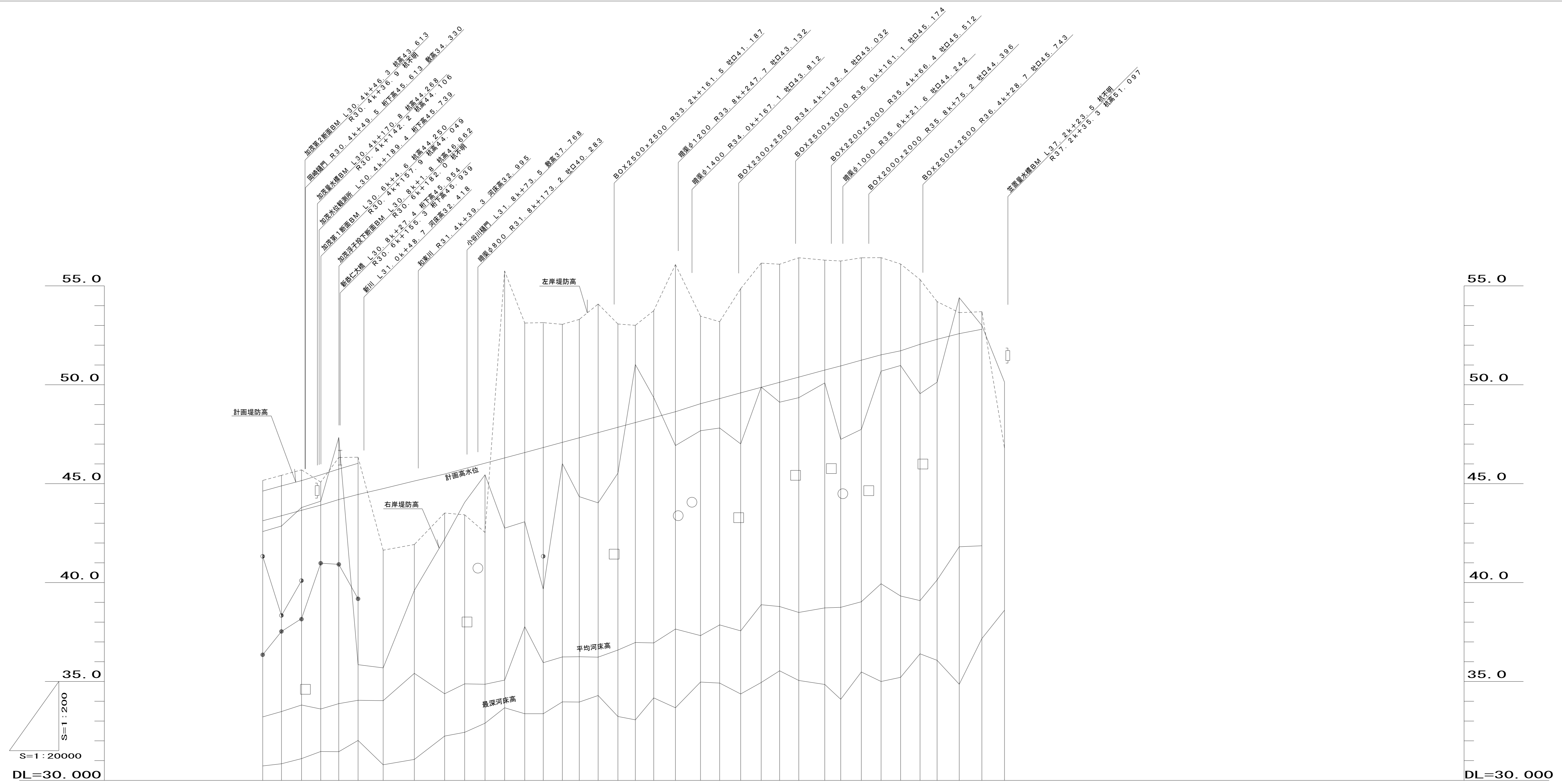

現況河床勾配	
計画堤防高	43.125~44.020
計画高水位	43.379~44.897
計画高水敷高	43.053~45.105
計画河床高	43.917~46.417
平均河床高	44.199~45.739
最深河床高	44.457~46.029
堤防高	右岸 44.751 左岸 45.126
堤内地盤高	右岸 45.888 左岸 45.940
距離標高	右岸 46.508 左岸 46.503
右岸距離標高	46.526
左岸距離標高	47.089
流心追加距離	47.320
流心区間距離	47.880
距離標	47.952
	48.591
	48.342
	48.538
	49.044
	49.300
	49.591
	49.872
	50.125
	50.387
	50.743
	50.982
	51.242
	51.513
	51.781
	52.048
	52.300
	52.585
	52.806
	46.811
	46.800

凡例	
量水標	
橋	
樋門・樋管・制水	
水準点	
計画	堤防高
	高水位
	高水敷高
	河床高
最深河床高	
堤防高	右岸
	左岸
平均河床高	
堤内地盤高	右岸
	左岸

・距離標高・堤防高については本業務にて更新
・堤内地盤高・平均河床高・最深河床高については平成23年度木津川縦断面測量業務の成果図より記載

作業機関 株式会社 エース

計測機関 近畿地方整備局淀川河川事務所